



3rd International Symposium
Childhood, Adolescent and
Young Adult Hodgkin Lymphoma
(ISCAYAHL)

May 11–13, 2017 | Georgetown University | Washington, DC



Childhood Adolescent and Young Adult Hodgkin Lymphoma

CONTENTS

Represented Countries	1
Welcome.....	2
Floor Plan of Georgetown University Campus	3
Floor Plan Leavey Center	4
Washington, D.C., Metro Map.....	5
General Information.....	6
Abstracts	
Internet Access	
Media Check/Speakers' Service	
Mobile Phones and Pagers	
Name Badges	
Poster Viewing	
Registration Desk and Check-In	
Welcome Reception	
CME Information	7
Acknowledgment	
Disclosure of Financial Relationships	
Organizing Committee and Invited Speakers.....	9
Symposium Agenda	12
Poster and Oral Abstract Information.....	15
List of Pre-Registered Attendees	19

REPRESENTED COUNTRIES

3rd ISCAY AHL delegates come from the following countries (as of April 12, 2017):

US	United States	64
DE	Germany	14
BR	Brazil	12
IT	Italy	7
NL	Netherlands	6
CA	Canada	5
GB	Great Britain	5
AU	Australia	4
JP	Japan	4
EG	Egypt	3
JO	Jordan	3
SE	Sweden	3
VE	Venezuela	3
AR	Argentina	2

CU	Cuba	2
ES	Spain	2
FR	France	2
HT	Haiti	2
AE	United Arab Emirates	1
AT	Austria	1
BO	Bolivia	1
CO	Colombia	1
CZ	Czech Republic	1
DK	Denmark	1
EC	Ecuador	1
GE	Georgia	1
GT	Guatemala	1
HK	Hong Kong	1

IE	Ireland	1
IL	Israel	1
IN	India	1
JM	Jamaica	1
MA	Morocco	1
MX	Mexico	1
NZ	New Zealand	1
PK	Pakistan	1
SI	Slovenia	1
SK	Slovakia	1
SN	Senegal	1
TW	Taiwan	1
ZA	South Africa	1

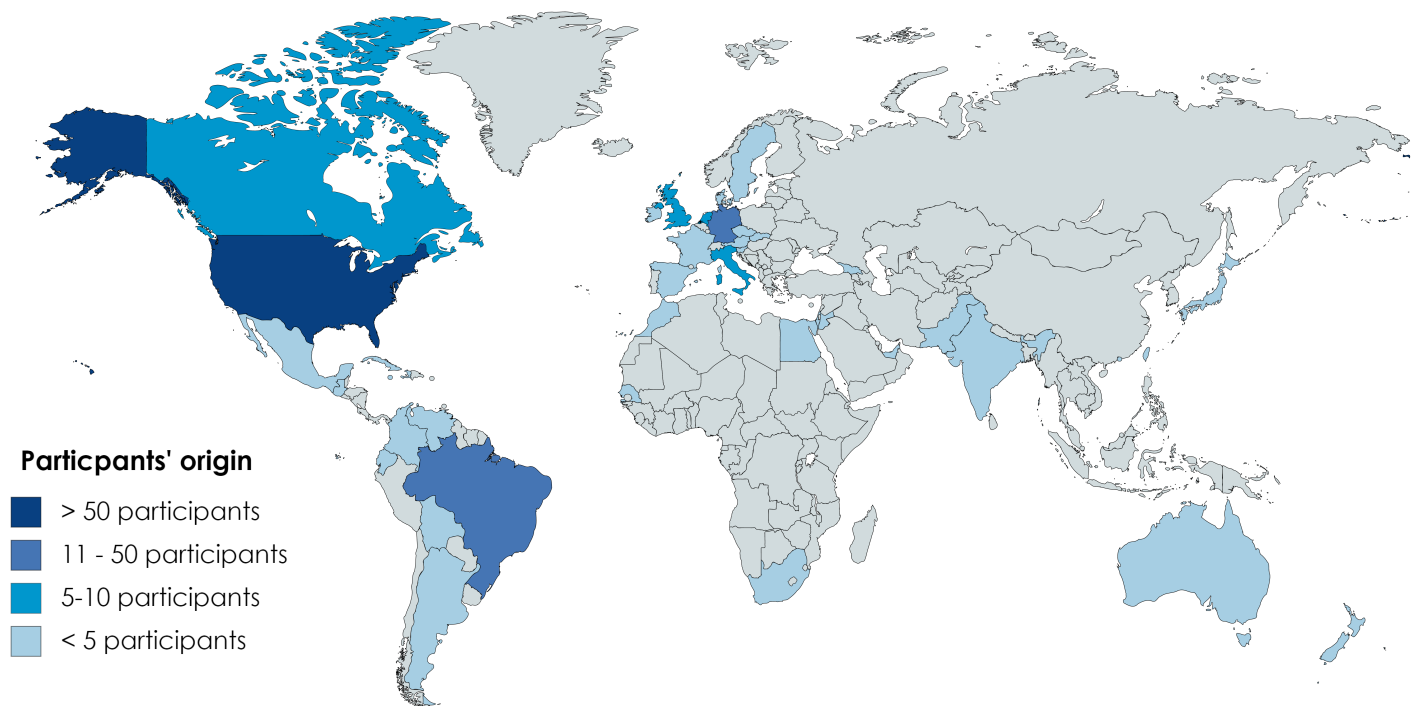

Created with mapchart.net ©

WELCOME!

Dear Friends and Colleagues,

Welcome to Washington, D.C., and the 3rd International Symposium on Childhood, Adolescent and Young Adult Hodgkin Lymphoma (ISCAY AHL). Since its inception, the symposium has truly been a successful international effort. This year, symposium organizers, speakers and participants represent more than 40 countries. We look forward to learning from them and sharing diverse perspectives as we work together to advance global science and treatment standards for this disease.

Among our highlights this year is a focus on staging and response criteria harmonization, including advanced and functional imaging methodologies. We believe that greater harmonization will improve clinical research collaborations and outcomes in the future. We are looking forward to learning from the contributions from our pediatric non-Hodgkin lymphoma colleagues, as well as our medical oncologist colleagues who have also, or are currently, working on similar efforts. In addition, we will be discussing emerging therapies for lymphoma, late effects in survivors, and current global collaborations. Back by popular demand will be two “meet the expert” sessions in which difficult and controversial cases will be presented and for which we expect enthusiastic audience participation.

At our last meeting in Berlin, in the presence of Dr. Günther Schellong, we awarded the first recipient of the Günther Schellong Award to Dr. Judith Landman-Parker. This year we will be awarding this prize to an investigator that has contributed significantly for the improvement of childhood and adolescent Hodgkin lymphoma worldwide. Capping off the symposium will be our poster award presentation.

During your visit, we hope you take the opportunity to explore all Washington has to offer. For your convenience, we have included in your program a map of the city’s Metro transportation system. Most of Washington’s major attractions, including museums and monuments, are easily accessible by public transportation.

We look forward to spending time with you over the next two days and learning from each other. Please let us know if you need assistance or if you have suggestions on how we may improve future conferences. Our next symposium is planned for 2020 in Berlin, Germany. We hope to see you there!

Sincerely,

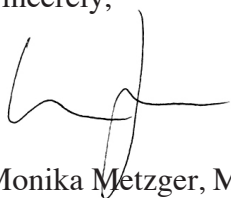

Monika Metzger, MD, MSc
Regional Director, South and Central American Regions
Member, Departments of Oncology and
Global Pediatric Medicine
St. Jude Children’s Research Hospital
262 Danny Thomas Place
Memphis, TN 38105
Tel: +1-901-595-4974
Fax: +1-901-521-9005
monika.metzger@stjude.org



Co-Chairs



Prof. Dr. Christine Mauz-Körholz
Leiterin der Hodgkin-Studienzentrale
Pädiatrische Hämatologie und Onkologie
Zentrum für Kinderheilkunde der
Justus-Liebig-Universität Gießen
Feulgenstraße 12
35392 Gießen
Tel: 0641-985-59524/-43667
Fax: 0641-985-43429
christine.mauz-koerholz@paediat.med.uni-giessen.de
hodgkin@paediat.med.uni-giessen.de

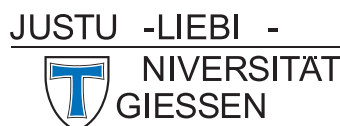

FLOOR PLAN GEORGETOWN UNIVERSITY CAMPUS

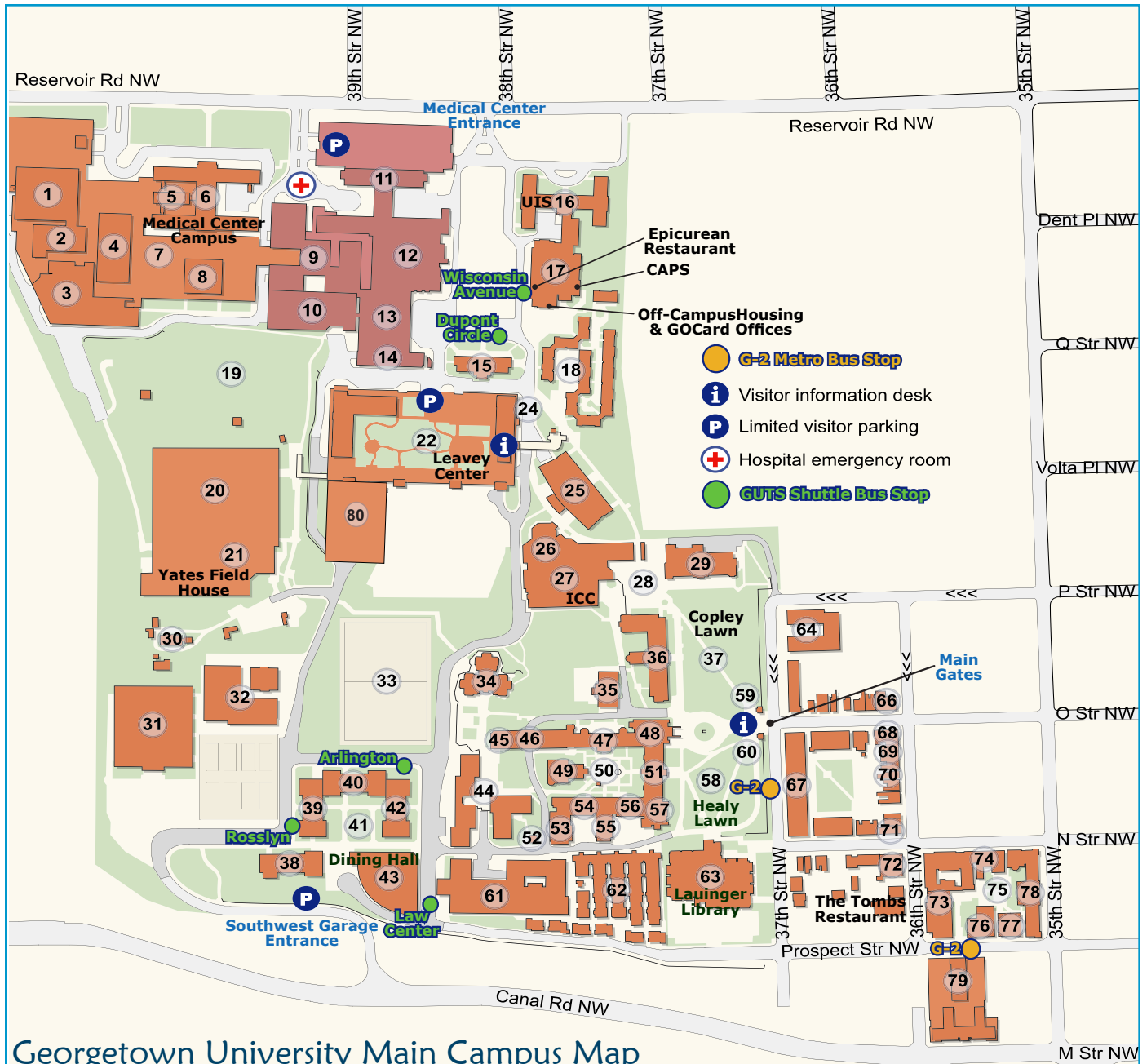

Georgetown University Main Campus Map

(70) Academic Administration
 (71) Academic Administration
 (68) Alumni House
 (67) Alumni Square (Village B)
 (4) Basic Science Building
 (12) Bless Building
 (1) Building D
 (27) Bunn Intercultural Center (ICC)
 (79) Car Barn
 (9) Concentrated Care Center
 (36) Copley Hall
 (37) Copley Lawn
 (49) Dahlgren Chapel
 (50) Dahlgren Quadrangle
 (17) Darvall Hall
 (35) Davis Performing Arts Center
 (75) East Campus Quadrangle (LXR)
 (48) Gaston Hall
 (11) Georgetown University Hospital
 (53) Gervase Building

(13) Gorman Building
 (72) GU Shops
 (33) Harbin Field
 (34) Harbin Hall (Housing Services 103)
 (51) Healy Hall
 (58) Healy Lawn
 (32) Heating and Cooling Plant
 (18) Henle Village (CAPS, Student Insurance)
 (26) ICC Auditorium
 (69) Institute of Diplomacy
 (38) Jesuit Residences – Wolfington Hall
 (20) Kehoe Field
 (40) Kennedy Hall
 (15) Kober Cogan Building
 (63) Lauinger Library
 (22) Leavey Center
 (10) Lombardi Cancer Center
 (78) Loyola Hall (LXR)
 (24) Main Shuttle Bus Stop
 (56) Maguire Hall

(42) McCarthy Hall
 (31) McDonough Gymnasium
 (45) McNeir Auditorium
 (52) McSherry Building
 (5) Medical & Dental Annex
 (6) Medical & Dental Building
 (54) Mulledy Building
 (74) Nevils Building
 (46) New North
 (3) New Research Building
 (61) New South
 (59) North Gatehouse
 (19) North Keyhoe Field
 (43) O'Donovan Dining Hall
 (30) Observatory
 (47) Old North
 (14) Pasquerilla Healthcare Center
 (64) Poulton Hall
 (7) Pre-Clinical Science (PSB)
 (80) Rafik B. Hariri Building

(28) Red Square
 (66) Reed Alumni Residence
 (25) Reiss Science Building
 (2) Research Resource Facility
 (39) Reynolds Hall
 (57) Riggs Library
 (55) Ryan Hall
 (76) Ryder Hall (LXR)
 (60) South Gatehouse
 (41) Southwest Quadrangle (SWQ)
 (16) St. Mary's Hall (UIS)
 (62) Village A
 (44) Village C (DPS, Alumni Lounge)
 (73) Walsh Building
 (29) White-Gravenor Hall
 (77) Xavier Hall (LXR)
 (21) Yates Field House

FLOOR PLAN LEAVEY CENTER

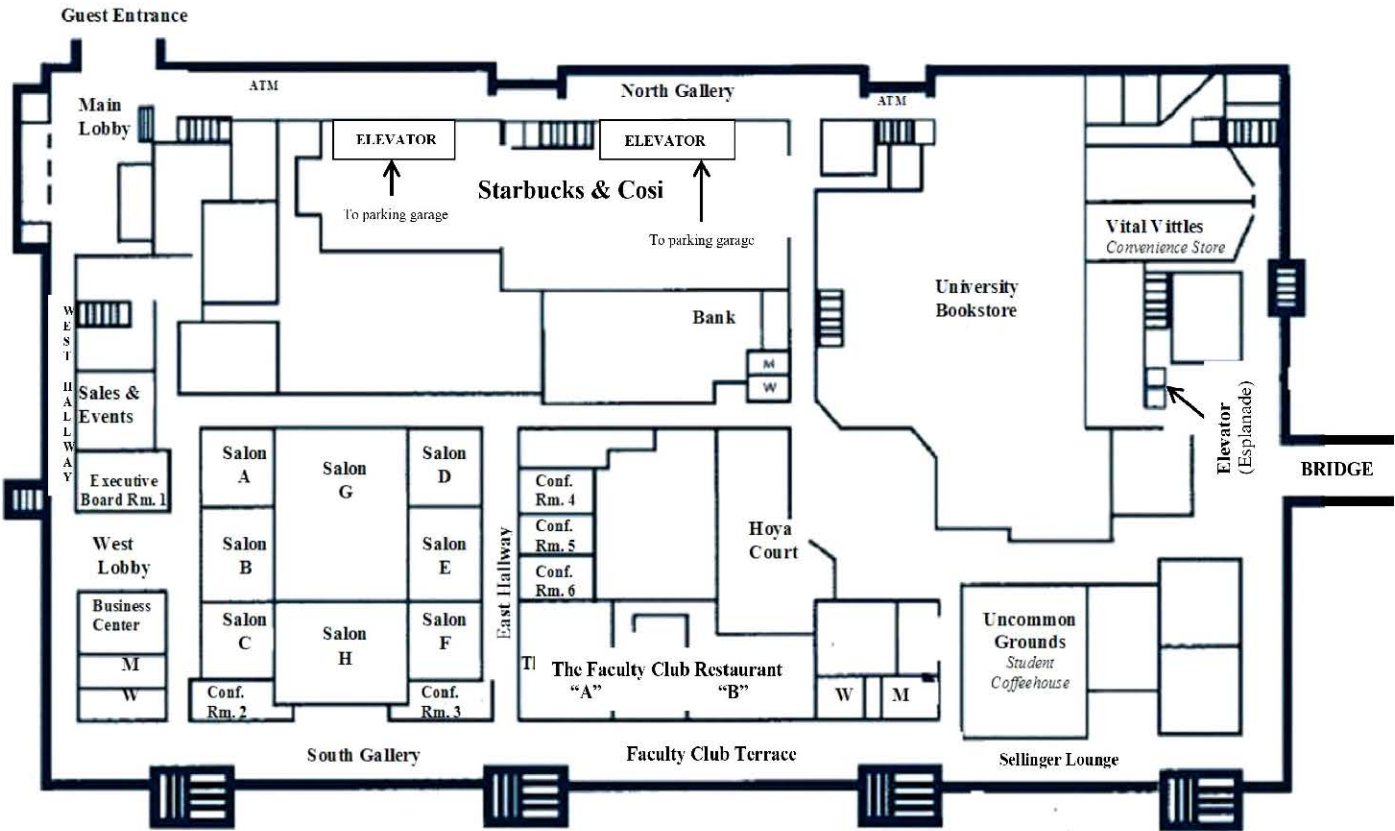

WASHINGTON, D.C., METRO MAP



wmata.com
 Customer Information Services: 202 637-7000
 TTY Phone: 202 638-5780
 Metro Transit Police: 202 982-2121

Legend

- RD Red Line • Glenmont / Shady Grove
- OR Orange Line • New Carrollton / Vienna
- BL Blue Line • Franconia-Springfield / Largo Town Center
- GR Green Line • Branch Ave / Greenbelt
- YL Yellow Line • Huntington / Fort Totten
- SV Silver Line • Wiehle-Reston East / Largo Town Center

Station Features

- Bus to Airport
- Parking
- Hospital
- Airport

Connecting Rail Systems

- AMTRAK
- VRE
- MARC

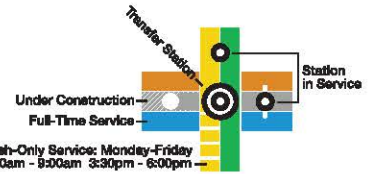

Metroall
Operating Times
Mon-Thu
 5am-midnight
Fri
 5am-3am
Sat
 7am-3am
Sun
 7am-midnight
 Times are approximate

Metro is accessible.
WASHINGTON METRO SYSTEM ACCESSIBILITY 1-2014

GENERAL INFORMATION

Abstracts

The abstracts of the oral presentations as well as the posters will be published in a peer review journal this year. The exact publication is not yet determined but will be made public as soon as the information is available.

Internet Access

Complimentary wireless internet is available throughout the conference center and guest rooms.

Media Check / Speakers' Service

There will be a marked media check for oral presentations. We kindly ask you to hand in your presentation on a flash drive about two hours in advance of your talk, at the latest, or the day before.

Mobile Phones and Pagers

As a courtesy to presenters and others, please ensure that mobile phones and pagers are turned off or switched to silent mode during all presentations.

Name Badges

Admission to all sessions and meals is by name badge only, and all attendees must be registered.

Poster Viewing

Posters can be set up throughout the day on May 11 and 12. Posters and stands are numbered and can be found at the end of this brochure. Poster viewing will be: Thursday, May 11, 2017 from 12:00 p.m. to 1:00 p.m. and Friday (presenters in attendance), May 12, 2017 from 11:50 a.m. to 1:30 p.m..

Registration Desk and Check In

The registration desk will be open in the West Lobby in the Leavey Center from 7:00 a.m. to 3:00 p.m. on Thursday, May 11 and from 7:00 a.m. to 12:00 p.m. on May 12 and May 13, 2017 for badge and symposium package pick-up. On-site registration will be available on all conference days. Registration fees can be paid in cash or by VISA, Mastercard or American Express.

Welcome Reception

Wine and cheese reception will be held at the South Gallery of the Leavey Center on Thursday, May 11 at 6:30 p.m.

Educational Objectives

After attending this educational conference, you should be able to:

- Describe the most recent advances in the epidemiological and etiological aspects of pediatric and young adult Hodgkin lymphoma
- Present current efforts of the staging evaluation and response criteria harmonization (SEARCH) for children, adolescents, and young adults with HL (CAYAHL) working groups
- Discuss recent research advances in the field of late effects and quality of life issues of long term survivors

Please note that session objectives will be presented during the conference as appropriate.

Accreditation Statement

St. Jude Children's Research Hospital is accredited by the Accreditation Council for Continuing Medical Education to provide continuing medical education for physicians.

Credit Designation

St. Jude Children's Research Hospital designates this live activity for a maximum of 17 *AMA PRA Category 1 Credits*[™]. Physicians should only claim credit commensurate with the extent of their participation in the activity.

Acknowledgment

This activity is supported by educational grants from Amgen, Bristol-Myers Squibb, Merck, and Seattle Genetics. The opinions expressed herein are those of the faculty and do not necessarily reflect the opinions of the CME provider, host department, St. Jude Children's Research Hospital, or the commercial supporters.

Evaluation and Certificates

To claim *AMA PRA Category 1 Credit*[™] or attendance credit for this activity, you must attend the sessions and complete the evaluation by following the instructions below:

- Go to www.stjude.org/cme-certificate.
- Enter the email address you used when registering for this conference and your password. (If you do not remember your password or have not previously used this system, follow the instructions.)
- Enter the CME activity code **34639**, which will take you to the evaluation.
- After completing the evaluation, choose the appropriate type of credit and enter the amount of time you spent at the conference (maximum 17.0 hours) to claim your credit. (Note that if you are claiming <10 credits, you will need to input a leading zero, e.g., 05.00 for 5 credits.)
- Print and/or save your certificate.

If you have questions about claiming your CME or attendance certificate, please contact us at cme@stjude.org.

CME INFORMATION

Disclosure of Financial Relationships

All individuals in a position to control the content of this CME activity (such as faculty, presenters, and planners) were asked to complete a statement regarding all relevant financial relationships between themselves or their spouse/partner and any commercial interest (defined by the ACCME as “any entity producing, marketing, re-selling, or distributing health care goods and services consumed by, or used on, patients”). St. Jude CME has reviewed and resolved any conflicts of interest that were identified.

All relevant relationships are disclosed below; besides those listed below, no other speakers, planners, or other individuals with control over content have disclosed relevant financial relationships with commercial interests for themselves or their spouse/partner.

Name	Role	Company	Type of Relationship
Steve Ansell	Planner, speaker	Bristol-Myers Squibb, Merck	Supported/ contracted research
Catherine Bollard	Planner, speaker	Collectis, Neximmune	Consultant fees
Michelle Fanale	Planner	Seattle Genetics, Takeda, Research to Practice, Plexus, Spectrum, Bristol-Myers Squibb, Merck	Honoraria, reimbursements
		Spectrum, Amgen, Merck, Bristol-Myers Squibb	Consultant fees
		Millennium, Seattle Genetics, Novartis, MedImmune, Celgene, Molecular Templates, Genetech, Gilead, Bristol-Myers Squibb, Merck	Supported/ contracted research
Ralf Küppers	Planner, speaker	Takeda	Consultant fees
Christian Steidl	Planner, speaker	Seattle Genetics, Juno Therapeutics	Consultant fees
		Tioma Therapeutics	Supported/ contracted research
Anas Younes	Planner, speaker	Bayer, BMS, Celgene, Incyte, Janssen, Sanofi, Seattle Genetics, Takeda Millennium, Genentech and Merck	Consultant fees
		Novartis, Johnson & Johnson, Curis, Roche, Bristol-Myers Squibb	Supported/ contracted research

ORGANIZING COMMITTEE AND INVITED SPEAKERS*

***Steve Ansell, MD**

Transplant Center, Bone Marrow Transplant Program
Mayo Clinic
Rochester, MN

Pedro de Alarcón, MD

William H. Albers Professor and Chair
Department of Pediatrics
University of Illinois
College of Medicine at Peoria
Peoria, IL

Alejandro M. Arancibia, MD

Instituto do Cancer Infantil RS ICI-RS
Porto Alegre - RS - Brazil

Auke Beishuizen, MD, PhD

Erasmus Medical Center
Rotterdam, Netherlands

***Nickhill Bhakta, MD**

Department of Global Pediatric Medicine
St Jude Children's Research Hospital
Memphis, TN

Catherine Bollard, MD, MBChB

Center for Cancer and Immunology Research
Children's National Medical Center
Washington, D.C.

Andreas Bräuninger, MD

Molecular Pathology
Justus-Liebig-University Gießen
Gießen, Germany

Birgit Burkhardt, MD, PhD

University Children's Hospital Munster
Pediatric Hematology/Oncology
Munster, Germany

Mauricio Castellanos, MD

Oncologia Pediatrica
Unidad Nacional de Oncologia Pediatrica
Guatemala, Central America

***Bruce Cheson, MD**

Division of Hematology/Oncology in the Department
of Medicine at Lombardi Comprehensive Cancer
Center
Georgetown University Medical Center
Washington, D.C.

John Choi, MD

Department of Pathology
St. Jude Children's Research Hospital
Memphis, TN

Peter D. Cole, MD

Associate Professor
Department of Pediatrics (Hematology/Oncology)
Albert Einstein College of Medicine
Bronx, NY

Sandy (Louis) Constine, MD

Professor
Department of Radiation Oncology
University of Rochester Medical Center
Rochester, NY

Karin Dieckmann, MD

Professor, Radiation Therapy
University of Vienna Medical School
Vienna, Austria

Michelle A. Fanale, MD

Associate Professor, Lymphoma/Myeloma
The University of Texas MD Anderson
Cancer Center
Houston, TX

Jamie Flerlage, MD

Department of Oncology
St. Jude Children's Research Hospital
Memphis, TN

Dirk Hasenclever, PhD

Biostatistics - University of Leipzig
Institut für Medizinische Informatik, Statistik
und Epidemiologie
Leipzig, Germany

David Hodgson, MD, MPH, FRCPC

Department of Radiation Oncology
Department of Health Policy, Management and
Evaluation
University of Toronto
Cancer Care Ontario Research Chair in Health
Services
Toronto, Ontario, Canada

Bradford S. Hoppe, MD, MPH

Department of Radiation Oncology
UF Health Proton Therapy Institute
University of Florida Health
Jacksonville, FL

Melissa Hudson, MD

Director, Cancer Survivorship Division
Co-Leader, Cancer Prevention & Control
St. Jude Children's Research Hospital
Memphis, TN

ORGANIZING COMMITTEE AND INVITED SPEAKERS*

***Martin Hutchings, MD, PhD**

Department of Hematology
The Finsen Centre, National Hospital
Copenhagen University Hospital
Copenhagen, Denmark

Sue C. Kaste, DO

Diagnostic Imaging
St. Jude Children's Research Hospital
Memphis, TN

Kara Kelly, MD

Pediatric Hematology/Oncology
Herbert Irving Pavilion
New York, NY 10032

Regine Kluge, MD

Professor Nuclear Medicine
University of Leipzig
Leipzig, Germany

Dieter Körholz, MD

Professor and Chair
Zentrum für Kinderheilkunde und
Jugendmedizin
UKGM Standort Gießen
Gießen, Germany

Matthew Krasin, MD

Associate Member
Radiation Oncology
St. Jude Children's Research Hospital
Memphis, TN

Ralf Küppers, PhD

Professor
Institute of Cell Biology (Cancer Research)
University of Duisburg-Essen
Essen, Germany

Judith Landman-Parker, MD

Hôpital Trousseau Assistance Publique-Hôpitaux de
Paris,
University of Pierre et Marie Curie
Paris, France

***Henrique Lederman, MD**

Center of Diagnostic Imaging – Radiology
GRAACC
Sao Paulo, Brazil

Megan Lim, MD, PhD

Associate Professor & Director
Hematopathology
University of Michigan
Ann Arbor, MI

***Amita Mahajan, MBBS, MD, MRCP**

Pediatric Hematology-Oncology
Indraprastha Apollo Hospitals,
New Delhi, India

Kathleen McCarten, MD

Pediatric Radiology
Rhode Island Medical Imaging
Providence, RI

***Claude Moreira, MD**

Unité d'oncologie Pédiatrique
Hôpital Aristide Le Dantec
Dakar, Senegal

***Kevin Oeffinger, MD**

Department of Medicine
Duke University School of Medicine
Durham, NC

***Susan Parsons, MD**

Professor of Medicine and Pediatrics
Tufts Medical Center
Boston, MA

Timothy Prestidge, MD

Pediatric Hematologist
Starship Children's Hospital
Grafton, Auckland

John T. Sandlund, MD

Department of Oncology
St. Jude Children's Research Hospital
Memphis, TN

Lawrence Schwartz, MD

Professor and Chairman
Department of Radiology
Columbia University Medical Center
New York, NY

***Roderick Skinner, MRCP, DCH, PhD, FRCPCH**

Honorary Professor of Childhood Cancer,
Northern Institute of Cancer Research
University of Newcastle
Newcastle, United Kingdom

Christian Steidl, MD

Department of Pathology and Experimental
Therapeutics
Centre for Lymphoid Cancers
British Columbia Cancer Agency
Vancouver, BC, Canada

ORGANIZING COMMITTEE AND INVITED SPEAKERS*

Dietrich Stoevesandt, MD

Department of Radiology
Martin Luther University
Halle-Wittenberg
Halle (Saale), Germany

Leanne Super, MD

Monash Children's Cancer Centre
The Royal Children's Hospital Melbourne
Melbourne, Australia

***Anke van den Berg, PhD**

Pathology & Medical Biology
University Medical Center Groningen
Groningen, Netherlands

David Alejandro Verón, MD

Pediatric Oncology
Hospital Posadas
Buenos Aires, Argentina

Stephen Voss, MD, PhD

Associate Professor of Radiology
Harvard Medical School, Children's Hospital Boston
Boston, Massachusetts

Hamish Wallace, MD, FRCP, FRCPCH, FRCS

Pediatric Oncology
Royal Hospital for Sick Children
Edinburgh, United Kingdom

***Anas Younes, MD**

Chief, Lymphoma Service
Memorial Sloan Kettering Cancer Center
New York, NY

SYMPOSIUM AGENDA

THURSDAY, MAY 11, 2017

7:00 a.m.	REGISTRATION OPEN
7:45 – 8:00 a.m.	WELCOME, INTRODUCTION, FACULTY DISCLOSURE Monika Metzger, Memphis, TN, USA Christine Mauz-Körholz, Giessen, Germany
8:00 – 9:45 a.m.	TRANSLATIONAL BIOLOGY Chairs: Ralf Küppers and Megan Lim
8:00 – 8:25 a.m.	Ralf Küppers - Pathogenesis of Hodgkin lymphoma
8:25 – 8:50 a.m.	Anke van den Berg - Novel insights in Hodgkin lymphoma susceptibility and pathogenesis
8:50 – 9:15 a.m.	Christian Steidl - Tumor microenvironment and survival in pediatric and adult Hodgkin lymphoma
9:15 – 9:45 a.m.	Oral Abstract Presentations <ul style="list-style-type: none">• Mid-treatment TARC and mid-treatment FDG-PET predict for progression-free survival in classical Hodgkin lymphoma (Anke van den Berg)• CCR5 blocking by Maraviroc-inhibited microenvironmental interactions and exerted antitumor activity in tumor xenograft model of classical Hodgkin lymphoma (Naike Casagrande)
9:45 – 10:15 a.m.	Coffee Break
10:15 a.m. – 12:00 p.m.	NOVEL THERAPIES Chair: Michelle Fanale and Auke Beishuizen
10:15 – 10:40 a.m.	Cath Bollard - T cell therapies for lymphomas - CARs and beyond
10:40 – 11:05 a.m.	Steve Ansell - Emerging new therapies and novel combinations in the management of Hodgkin lymphoma
11:05 – 11:30 a.m.	Anas Younes - PD-1 Targeted therapy for Hodgkin lymphoma
11:30 a.m. – 12:00 p.m.	Oral Abstract Presentations <ul style="list-style-type: none">• Risk-adapted therapy utilizing upfront Brentuximab vedotin (Bv) and Rituximab in children, adolescents and young adults with Hodgkin lymphoma (Jessica Hochberg)• Comparison of outcomes of hematopoietic transplantation for children and AYAs with Hodgkin lymphoma in Japan (Yuhki Koga)
12:00 – 1:00 p.m.	Lunch and Poster Viewing
1:00 – 2:15 p.m.	PEDIATRIC NON-HODGKIN HARMONIZATION CRITERIA Chair: Birgit Burkhardt
1:00 – 1:25 p.m.	John Sandlund - International response criteria for non-Hodgkin lymphoma
1:25 – 1:50 p.m.	Birgit Burkhardt - Risk stratification for contemporary non-Hodgkin lymphoma protocol therapy
1:50 – 2:15 p.m.	John Choi and Sue Kaste - Current and future state of diagnostic tools (pathology and diagnostic imaging)
2:15 – 2:30 p.m.	Coffee Break
2:30 – 4:20 p.m.	STAGING EVALUATION AND RESPONSE CRITERIA HARMONIZATION (SEARCH) FOR CAYAH Chairs: Jamie Flerlage and Dieter Körholz
2:30 – 2:50 p.m.	Christine Mauz-Körholz - EuroNet-PHL: response criteria
2:50 – 3:10 p.m.	Kara Kelly - COG: Response criteria
3:10 – 3:20 p.m.	Monika Metzger - Bridging the gap

SYMPOSIUM AGENDA

3:20 – 4:20 p.m.	Oral Abstract Presentations <ul style="list-style-type: none">• A lymph node staging atlas (Dietrich Stoevesandt)• Consensus guidelines for Waldeyer's ring involvement in pediatric Hodgkin lymphoma (Jessika Seelisch)• Pericardial effusion in Hodgkin lymphoma: Children's Oncology Group protocol AHOD0031 (Lianna Marks)• Liver involvement in pediatric Hodgkin lymphoma: a systematic review (Melanie M. Hagleitner)
4:20 – 5:20 p.m.	ADULT HODGKIN LYMPHOMA HARMONIZATION CRITERIA Chair: Larry Schwartz
4:20 – 4:50 p.m.	Bruce Cheson - Development of the staging and response criteria for adult lymphomas
4:50 – 5:20 p.m.	Martin Hutchings - The evolving role of PET/CT and PET-guided therapy in adult Hodgkin lymphoma
6:30 p.m.	WELCOME RECEPTION

FRIDAY, MAY 12, 2017

7:00 a.m.	REGISTRATION OPEN
8:00 – 9:30 a.m.	MEET THE EXPERT
9:30 – 10:00 a.m.	Coffee Break
10:00 – 11:50 a.m.	GLOBAL COLLABORATIONS IN PEDIATRIC HODGKIN LYMPHOMA Chairs: Hamish Wallace and David Veron
10:00 – 10:25 a.m.	Amita Mahajan - Hodgkin lymphoma experience in India
10:25 – 10:50 a.m.	Claude Moreira - Hodgkin lymphoma in Africa: the GFAOP experience
10:50 – 11:50 a.m.	Oral Abstract Presentations <ul style="list-style-type: none">• Long-term results of combined ABVD and restricted radiotherapy in children and adolescent Hodgkin lymphoma (Pedro Zubizarreta)• Human immunodeficiency virus and autoimmune disorders are associated with lower survival rates in children treated for Hodgkin lymphoma in South Africa. (Jennifer Geel)• Results of the Italian Association of Pediatric Hematology and Oncology (AIEOP) LH-2004 protocol (Roberta Burnelli)• Hodgkin lymphoma in Egyptian children: CCHE Experience (Alaa El Haddad)
11:50 a.m. – 1:30 p.m.	Lunch and Poster Viewing (Presenters in attendance)
1:30 – 3:05 p.m.	THE FUTURE OF DIAGNOSTIC IMAGING IN PEDIATRIC HODGKIN LYMPHOMAS Chairs: Sue Kaste and Dietrich Stoevesandt
1:30 – 1:55 p.m.	Regine Kluge - Prognostic value of PET/CT and PET/MR beyond the Deauville score
1:55 – 2:20 p.m.	Henrique Lederman - Whole-body diffusion MRI in pediatric Hodgkin lymphoma
2:20 – 3:05 p.m.	Oral Abstract Presentations <ul style="list-style-type: none">• Raising the FDG-PET threshold for radiotherapy indication after 2 OEPA from Deauville 3+ to Deauville 4+ results in substantial reduction in radiotherapy use without increase in relapse rate in all stage cHL in children and young people - a single institution experience (Stephen Daw)• Detection and response assessment of bone marrow and bone lesions in pediatric Hodgkin lymphoma - FDG-PET is an appropriate tool (Thomas Georgi)

SYMPOSIUM AGENDA

- Prognostic value of quantitative positron emission tomography early-response assessment in pediatric Hodgkin lymphoma patients treated within the GPOH-HD-2002 trial (Lars Kurch)

3:05 – 3:30 p.m.

Coffee Break

3:30 – 5:15 p.m.

OPTIMIZING TREATMENT INTENSITY IN PEDIATRIC HODGKIN LYMPHOMA: HOW FAR ARE WE FROM PERSONALIZED TREATMENT?

Chairs: Sandy Constine and Judith Landman-Parker

3:30 – 3:45 p.m.

Susan Parsons - Translating results from clinical trials to shared decision making: decision modeling may show us the way

3:45 – 4:00 p.m.

Brad Hoppe - Minimizing the risk of late toxicities from radiation through modern field design and novel treatment techniques

4:00 – 4:30 p.m.

Panel: Karin Diekmann, David Hodgson, Dieter Körholz, Kara Kelly

4:30 – 5:15 p.m.

Oral Abstract Presentations

- Volumetric anatomic and metabolic response modelling of pediatric Hodgkin lymphoma patients treated with Stanford V chemotherapy: impact of initial extent of disease and Ann Arbor site (Omar Mohammed)
- TEDDI: Radiotherapy delivery in deep inspiration for pediatric Hodgkin lymphoma - A pilot study - A deep breath may prolong your life! (Anni Young Stensgaard Joergensen)
- Treatment patterns and disease outcomes of patients with progressive or relapsed Hodgkin lymphoma subsequently treated with curative-intent radiotherapy (Christopher Tinkle)

5:15 – 5:45 p.m.

GÜNTHER SCHELLONG AWARD SESSION

SATURDAY, MAY 13, 2017

7:00 a.m.

REGISTRATION OPEN

8:00 – 9:30 a.m.

MEET THE EXPERT

9:30 – 10:00 a.m.

Coffee Break

10:00 – 11:45 a.m.

PERSPECTIVES ON SURVEILLANCE OF LATE EFFECTS IN HODGKIN LYMPHOMA SURVIVORS

Chairs: Peter Cole and Leanne Super

10:00 – 10:25 a.m.

Kevin Oeffinger - Balancing risks, harms and benefits of late-effects surveillance

10:25 – 10:50 a.m.

Nickhill Bhakta - Predicting trends in late effects to guide treatment planning and late-effects surveillance

10:50 – 11:15 a.m.

Rod Skinner - Surveillance of late effects in Hodgkin lymphoma– What do the survivors know and think?

11:15 – 11:45 a.m.

Oral Abstract Presentation

- Subsequent malignant neoplasms among children and adolescents with Hodgkin lymphoma treated with response-adapted therapy: a report from the Children's Oncology Group study AHOD0031 (Lisa Giulino-Roth)
- Late effects after Hodgkin lymphoma in childhood and adolescence - the German survivor cohort after 21 years of follow-up (Ulrike Hennewig)

11:45 a.m. – 12:30 p.m.

POSTER AWARD SESSION

FAREWELL AND SETTING GOALS FOR THE NEXT MEETING (2020 BERLIN)

POSTER AND *ORAL ABSTRACT INFORMATION

Translational Biology

101	Hema Dave	Feasibility of xMAP technology for detection of biomarkers in pediatric high risk Hodgkin lymphoma in the setting of a cooperative group phase III clinical trial
102	Robert E. Hutchison	Variant histology with IgD expression is frequent in pediatric nodular lymphocyte predominant Hodgkin lymphoma, but neither these nor CD30 expression predict adverse outcome: a report from the Children's Oncology Group
103	Michi Kamei	Retrospective analysis of the clinical profile of and therapy response in pediatric patients with nodular lymphocyte predominant Hodgkin lymphoma: a report from the Japan Children's Cancer Group
104	De Re Valli	HLA-G factor affecting tumor relapse in pediatric Hodgkin lymphoma
*105	Naike Casagrande	CCR5 blocking by Maraviroc-inhibited microenvironmental interactions and exerted antitumor activity in tumor xenograft model of classical Hodgkin lymphoma
*106	Anke van den Berg	Mid-treatment TARC and mid-treatment FDG-PET predict for progression-free survival in classical Hodgkin lymphoma
107	Rui Wu	Mass spectrometry-based proteomic profiling of Hodgkin lymphoma
108	Iliia Buhtoiarov	Case report of classical Hodgkin lymphoma of the cystic thymus in a patient with infectious mononucleosis: diagnostic challenges and practical considerations

Novel Therapies

201	Luiza de Souza Santos Milare	Outcome from autologous hematopoietic stem cell transplantation in Hodgkin lymphoma: experience from a single pediatric oncology center in Brazil
*202	Jessica Hochberg	Risk-adapted therapy utilizing upfront Brentuximab vedotin (Bv) and Rituximab® with reduced toxicity chemotherapy in children, adolescents and young adults with Hodgkin lymphoma
203	Sergio M. Gomez	Autologous stem cell transplantation (ASCT) for relapsed/refractory Hodgkin lymphoma in childhood
204	Palma Solano-Paez	Successful re-treatment with Brentuximab vedotin in a teenager with primary refractory Hodgkin lymphoma
*205	Yuhki Koga	Comparison of outcomes of hematopoietic transplantation for children and AYAs with Hodgkin lymphoma in Japan
206	Jamie Flerlage	Brentuximab vedotin as consolidation therapy post hematopoietic stem cell transplant for the treatment of relapsed Hodgkin lymphoma in pediatric patients: a retrospective case series

Global Collaborations in Pediatric Hodgkin Lymphoma

301	Tim Prestidge	Nationwide outcomes for pediatric classical Hodgkin lymphoma in New Zealand following change to EuroNet protocol
302	Mauricio Castellanos	A risk-adapted, response-based therapeutic regimen using OEPA/ COPDAC for the treatment of children with high-risk Hodgkin lymphoma; from the AHOPCA group
303	Luciana dos Santos Domingues	Hodgkin lymphoma in childhood: a 25-year experience of a single institution in Brazil
*304	Pedro Zubizarreta	Long-term results of combined ABVD and restricted radiotherapy in children and adolescent Hodgkin lymphoma
305	Mauricio Castellanos	A response-based ABVD regimen with or without radiotherapy for pediatric patients with low- and intermediate-risk Hodgkin lymphoma in Central America and Dominican Republic: a report from AHOPCA
306	Roberto Roecker	Hodgkin lymphoma in children younger than 5 years old: experience of a single institution
307	Leanne Super	Nodular lymphocyte predominant Hodgkin lymphoma (nLPHL) in children: a single institution audit review
308	Matthew M.K. Shing	Treatment outcome of a multi-centre clinical study of Hodgkin lymphoma: a report by Hong Kong Paediatric Haematology and Oncology Study Group
309	David A. Veron	Pediatric Hodgkin lymphoma in Argentina: the GATLA experience
310	Elizabeth Alfaro	Nodular lymphocyte predominant Hodgkin lymphomas: experience in a single institution in Argentina
312	Alia Ahmad	Outcome of Hodgkin lymphoma in a developing country: The Children's Hospital Lahore Pakistan experience
313	Tomasz Klekawka	Paraneoplastic syndromes - unusual presentations of Hodgkin lymphoma in Polish Paediatric Leukaemia / Lymphoma Study Group patients
314	Amita Mahajan	Early experience with InPOG-HL-15-01: the first collaborative initiative of the Indian Pediatric Oncology Group
315	Mauricio Castellanos	Hodgkin lymphoma and tuberculosis in children and adolescents in Guatemala and Argentina
316	Ben Barak Ayelet	Relapsed and refractory Hodgkin lymphoma in children and adolescents: retrospective study in Israel 1999-2014
317	Alejandro Arancibia	Treatment of children and adolescents with Hodgkin lymphoma in Brazil: LHBRA2015 protocol

POSTER AND *ORAL ABSTRACT INFORMATION

318	Faiha Bazzeh	Is pediatric Hodgkin lymphoma in Jordan different than patients registered in SEER?
*319	Jennifer Geel	Human immunodeficiency virus and autoimmune disorders are associated with lower survival rates in children treated for Hodgkin lymphoma in South Africa.
320	Shih-Hsiang Chen	Clinical features and treatment outcomes of children with Hodgkin lymphoma in Taiwan: a single center experience
*321	Roberta Burnelli	Results of the Italian Association of Pediatric Hematology and Oncology (AIEOP) LH-2004 protocol
322	Tahani Sarrawi	Treating high-risk Hodgkin lymphoma using two protocols: higher price for higher survival
*323	Alaa El Haddad	Hodgkin lymphoma in Egyptian children; CCHE Experience
324	David Veron	Rare presentations of Hodgkin Lymphoma in Children and Adolescents: A Multicenter Experience in Latin America and the United States

Staging Evaluation and Response Criteria Harmonization (SEARCH) for CAYAHL

*601	Jennifer Seelisch	Consensus guidelines for Waldeyer's ring involvement in pediatric Hodgkin lymphoma; on behalf of SEARCH for CAYAHL
*602	Lianna J. Marks	Pericardial effusion in Hodgkin lymphoma: Children's Oncology Group protocol AHOD0031
*603	Melanie M. Hagleitner	Liver involvement in pediatric Hodgkin lymphoma: a systematic review on behalf of SEARCH for CAYAHL
604	Steve Y. Cho	Comparison of chest x-ray and CT-defined mediastinal bulk in a high-risk Hodgkin's lymphoma study (COG AHOD0831)
605	Eline Zijtregtop	E-lesions in pediatric Hodgkin lymphoma; a systematic review on behalf of SEARCH for CAYAHL

The Future of Diagnostic Imaging in Pediatric Hodgkin Lymphomas

701	Henrique Lederman	Comparative study between diffusion whole body magnetic resonance imaging and PET-CT on childhood, adolescent and young adult Hodgkin lymphoma care
*702	Stephen Daw	Raising the FDG-PET threshold for radiotherapy indication after 2 OEPA from Deauville 3+; to Deauville 4+; results in substantial reduction in radiotherapy use without increase in relapse rate in all stage cHL in children and young people - a single centre experience
*703	Thomas Georgi	Detection and response assessment of bone marrow and bone lesions in pediatric Hodgkin lymphoma - FDG-PET is an appropriate tool.

POSTER AND *ORAL ABSTRACT INFORMATION

*704	Lars Kurch	Prognostic value of quantitative positron emission tomography early-response assessment in pediatric Hodgkin lymphoma patients treated within the GPOH-HD-2002 trial
------	------------	--

Optimizing Treatment Intensity in Pediatric Hodgkin Lymphoma: How Far Are We From Personalized Treatment?

*801	Omar Mohammed	Volumetric anatomic and metabolic response modelling of pediatric Hodgkin lymphoma patients treated with Stanford V chemotherapy: impact of initial extent of disease and Ann Arbor site
802	Nmazuo W. Ozuah	Prognostic value of early response FDG-PET and ESR in children and adolescents with early-stage Hodgkin lymphoma
*803	Anni Young Stensgaard Joergensen	TEDDI: radiotherapy delivery in deep inspiration for pediatric Hodgkin lymphoma - a pilot study - A deep breath may prolong your life!
*804	Christopher L. Tinkle	Treatment patterns and disease outcomes of patients with progressive or relapsed Hodgkin lymphoma subsequently treated with curative-intent radiotherapy

Perspectives on Surveillance of Late Effects in Hodgkin Lymphoma Survivors

901	Cepelova Michaela	Incidence of hyperlipoproteinemia in long-term survivors of Hodgkin lymphoma in childhood or adolescence
902	Grace Lam	Late effects among children with Hodgkin lymphoma: a report by Hong Kong Paediatric Haematology and Oncology Study Group
903	Wei Shen	Pilot study on body composition in relation to constitutional symptoms during 6-week chemotherapy in pediatric Hodgkin lymphoma
904	Tara O. Henderson	Feasibility of patient-reported outcomes (PROs) in a phase III clinical trial for advanced stage classical Hodgkin lymphoma (cHL) in children and adolescents
*905	Lisa Giulino-Roth	Subsequent malignant neoplasms among children and adolescents with Hodgkin lymphoma treated with response-adapted therapy: a report from the Children's Oncology Group Study AHOD0031
*906	Ulrike Hennewig	Late effects after Hodgkin lymphoma in childhood and adolescence - the German survivor cohort after 21 years of follow-up

LIST OF PRE-REGISTERED ATTENDEES

A			
Ahmad	Alia	PK	alia_ahmad99@yahoo.com
Aldinucci	Donatella	IT	daldinucci@cro.it
Ansell	Steve	US	ansell.stephen@mayo.edu
Appel	Burton	US	Burton.Appel@hackensackmeridian.org
Arancibia	Alejandro	BR	alejandro.m.arancibia@gmail.com
B			
Balakumaran	Arun	US	arun.balakumaran@merck.com
Baumann	Julia	DE	Julia.Baumann@paediat.med.uni-giessen.de
Bazze	Faiha	JO	rshtayyeh@khcc.jo
Beishuizen	Auke	NL	a.beishuizen@erasmusmc.nl
Ben Barak	Ayelet	IL	a_ben-barak@rambam.health.gov.il
Bhakta	Nickhill	US	Nickhill.bhakta@stjude.org
Billett	Amy	US	amy_billett@dfci.harvard.edu
Blois	Thamires	BR	thamiresblois@gmail.com
Bollard	Catherine	US	CBollard@childrensnational.org
Bräuninger	Andreas	DE	andreas.braeuninger@patho.med.uni-giessen.de
Brumatti	Melina	BR	mebrumatti@yahoo.com.br
Buhtoiarov	Ilia	US	buhtoi@ccf.org
Burkhardt	Birgit	DE	Birgit.burkhardt@ukmuenster.de
Burnelli	Roberta	IT	roberta.burnelli@unife.it
C			
Cairo	Mitchell	US	mitchell_cairo@nymc.edu
Casagrande	Naike	IT	naike.casagrande@libero.it
Castellanos	Mauricio	GT	castellanoserick@hotmail.com
Castellino	Sharon	US	Sharon.castellino@choa.org
Cepelova	Michaela	CZ	michaela.cepelova@fnmotol.cz
Champagne	Josette	CA	josette.champagne@umontreal.ca
Chen	Shih-Hsiang	TW	samechen@cgmh.org.tw
Cheson	Bruce	US	bdc4@georgetown.edu
Cho	Steve	US	scho@uwhealth.org
Choi	John	US	johnkim.choi@stjude.org
Claviez	Alexander	DE	a.claviez@pediatrics.uni-kiel.de
Cole	Peter	US	peter.cole@einstein.yu.edu
Constine	Sandy (Louis)	US	Louis_Constine@urmc.rochester.edu
D			
Dave	Hema	US	hkdave@cnmc.org
Daw	Stephen	GB	stephen.daw@uclh.nhs.uk
de Alarcon	Pedro	US	pdealarc@uicomp.uic.edu
De Mateo	Elena	AR	elenadematteo@gmail.com
Dean	Jennifer	US	jdean@psvcare.org
Dieckmann	Karin	AT	karin.dieckmann@meduniwien.ac.at
Domingues	Luciana	BR	ludsdomingues@hotmail.com

LIST OF PRE-REGISTERED ATTENDEES

E			
Ehrhardt	Matthew	US	matthew.ehrhardt@stjude.org
Elhaddad	Alaa	EG	alaaelhaddad@hotmail.com
Elia	Caterina	IT	eliacaterina@libero.it
F			
Fanale	Michelle	US	mfanale@mdanderson.org
Fawzy	Mohamed	EG	mfawzyonc@hotmail.com
Fernandez	Karen	US	kfernandez@valleychildrens.org
Fernandez-Teijeiro	Ana	ES	anateijeiro@hotmail.com
Fiaccadori	Valeria	GB	valeria.fiaccadori@uclh.nhs.uk
Flerlage	Jamie	US	jamie.flerlage@stjude.org
Franklin	Anna	US	anna.franklin@childrenscolorado.org
Friedman	Debra	US	debra.l.friedman@vanderbilt.edu
Furtado de Azevedo	Erika	BR	efurtadoazevedo@gmail.com
G			
Garcia Guevara	Raiza	VE	raizagarciaguevara@gmail.com
Geel	Jennifer	ZA	jennifer.a.geel@gmail.com
Georgi	Thomas	DE	thomas.georgi@medizin.uni-leipzig.de
Guererri	Karla	US	karlaguererri@gmail.com
H			
Hagleitner	Melanie	NL	melanie.hagleitner@radboudumc.nl
Harker-Murray	Paul	US	pharker@mcw.edu
Hasenclever	Dirk	DE	dirk.hasenclever@imise.uni-leipzig.de
Henderson	Tara	US	thenderson@peds.bsd.uchicago.edu
Hennewig	Ulrike	DE	ulrike.hennewig@paediat.med.uni-giessen.de
Hochberg	Jessica	US	jessica_hochberg@nymc.edu
Hodgson	David	CA	david.hodgson@rmp.uhn.on.ca
Hoppe	Bradford	US	bhoppe@floridaproton.org
Hori	Daiki	JP	pippen33_dh@yahoo.co.jp
Horton	Terzah	US	tmhorton@txch.org
Hudson	Melissa	US	melissa.hudson@stjude.org
Hutchings	Martin	DK	martin.hutchings@gmail.com
Hutchison	Robert	US	hutchisb@upstate.edu
J			
Jacobs	Shana	US	ssjacobs@cnmc.org
Jarrar	Mohammad	CA	mohjarrar69@yahoo.com
K			
Kamei	Michi	JP	mkamei@med.nagoya-cu.ac.jp
Karlen	Jonas	SE	jonas.karlen@sl.se
Kaste	Sue	US	sue.kaste@stjude.org
Kawan	Lars	SE	lars.kawan@vgregion.se
Keller	Frank	US	frank.keller@choa.org
Kelly	Kara	US	kara.kelly@roswellpark.org

LIST OF PRE-REGISTERED ATTENDEES

Kersun	Leslie	US	segall@email.chop.edu
Kluge	Regine	DE	regine.kluge@medizin.uni-leipzig.de
Kobayashi	Ryoji	JP	r-koba@jacsl.jp
Körholz	Dieter	DE	dieter.koerholz@paediat.med.uni-giessen.de
Koga	Yuhki	JP	yuuki-k@pediatr.med.kyushu-u.ac.jp
Krasin	Matthew	US	matthew.krasin@stjude.org
Küppers	Ralf	DE	Ralf.Kueppers@uk-essen.de
Kurch	Lars	DE	lars.kurch@medizin.uni-leipzig.de
L			
Lam	Grace	HK	gracelam@gmail.com
Landman-Parker	Judith	FR	judith.landman-parker@aphp.fr
LeBlanc	Thierry	FR	thierry.leblanc@aphp.fr
Lederman	Henrique	BR	henrique.lederman@gmail.com
Lewis	Jocelyn	US	lewisj5@cinj.rutgers.edu
Lim	Megan	US	megan.lim@uphs.upenn.edu
Little	Margaret	AU	madge.little@gmail.com
Lowe	Eric	US	eric.lowe@chkd.org
Lucas	John	US	John.Lucas@STJUDE.ORG
Luisi	Flavio	BR	luisi@osite.com.br
Luna-Fineman	Sandra	US	slunafi@stanford.edu
M			
Mahajan	Amita	IN	mahajanamita1@gmail.com
Marks	Lianna	US	lianna.marks@gmail.com
Martinez-Albarran	Manuel Donovan	MX	donovanmtz73@hotmail.com
Mascarin	Maurizio	IT	mascarin@cro.it
Mauz-Körholz	Christine	DE	christine.mauz-koerholz@paediat.med.uni-giessen.de
McCarten	Kathleen	US	KMcCarten@Lifespan.org
Metzger	Monika	US	monika.metzger@stjude.org
Meyer-Wentrup	Friederike	NL	f.meyer-wentrup@prinsesmaximacentrum.nl
Mohammed	Omar	US	omohammed786@hotmail.com
Montilva	Rosario	VE	rmontilva@hotmail.com
Morais	Adriana	BR	dicamorais@hotmail.com
Moreira	Claude	SN	drcmoreira@gmail.com
N			
Nahar	Akash	US	akash.nahar@merck.com
O			
Oeffinger	Kevin	US	kevin.oeffinger@duke.edu
Ortolan	Marina	BR	mcortolan@hotmail.com
Ozuah	Nmazuo	US	nmazuo_ozuah@dfci.harvard.edu
P			
Parsons	Susan	US	sparsons@tuftsmedicalcenter.org
Pears	Jane	IE	janepears@doctors.org.uk
Pereira	Augusto	VE	pereira.augusto@gmail.com

LIST OF PRE-REGISTERED ATTENDEES

Pham	Rick	US	rickpham2008@yahoo.com
Prestidge	Tim	NZ	timp@adhb.govt.nz
Punnett	Angela	CA	angela.punnett@sickkids.ca
R			
Rajic	Vladan	SI	jurij.nared@tentours.si
Ranta	Susanna	SE	susanna.ranta@ki.se
Reece-Mills	Michelle	JM	michreecemills@yahoo.com
Roecker	Roberto	BR	beto_roecker@hotmail.com
Rosignoli	Chiara	IT	chiara.rosignoli@student.unife.it
Roth	Lisa	US	lgr2002@med.cornell.edu
S			
Sacchi	Mariana	US	Mariana.Sacchi@bms.com
Sala	Alessandra	IT	ale.sala@asst-monza.it
Sandlund	John T.	US	John.Sandlund@stjude.org
Schwartz	Cindy	US	clschwartz@gmail.com
Schwartz	Lawrence	US	lhs2120@cumc.columbia.edu
Scotto	Julie	US	julie.scotto@bms.com
Seelisch	Jennifer	CA	jennifer.seelisch@sickkids.ca
Shing	Matthew Ming Kong	AU	mk-shing@cuhk.edu.hk
Skinner	Roderick	GB	roderick.skinner@newcastle.ac.uk
Solano Paez	Maria de la Palma	ES	takeda@viajeseci.es
Sprlak	Michal	SK	misosprlak@gmail.com
Steidl	Christian	CA	CSteidl@bccancer.bc.ca
Stoevesandt	Dietrich	DE	dietrich.stoevesandt@medizin.uni-halle.de
Super	Leanne	AU	leanne.super@rch.org.au
T			
Taj	Mary	GB	mary.taj@icr.ac.uk
Tejani	Irfan	US	irfan.tejani@merck.com
V			
van den Berg	Anke	NL	a.van.den.berg01@umcg.nl
Veening	Margreet	NL	ma.veening@vumc.nl
Veron	David Alejandro	AR	davidveronhonc@gmail.com
W			
Wallace	William Hamish	GB	hamish.wallace@nhs.net
Walsh	Michele	US	michele.walsh@merck.com
Whyte	Morag	AU	moragwhyte@live.com
Wimberley	Sophie	US	zambonie@sbcglobal.net
Woodcheke	Amy	US	amy.woodcheke@nemours.org
Wu	Rui	US	ruiwu@mail.med.upenn.edu
Y			
Younes	Anas	US	younesa@mskcc.org
Z			
Zijtregtop	Eline	NL	e.zijtregtop@erasmusmc.nl
Zubizarreta	Pedro	AR	pedro.zubizarreta@hotmail.com

